

HOB:HOB+FA TYPE

方型重型油压缸FA板尺寸图 14Mpa Hydraulic Cylinders FA Dimensional Features

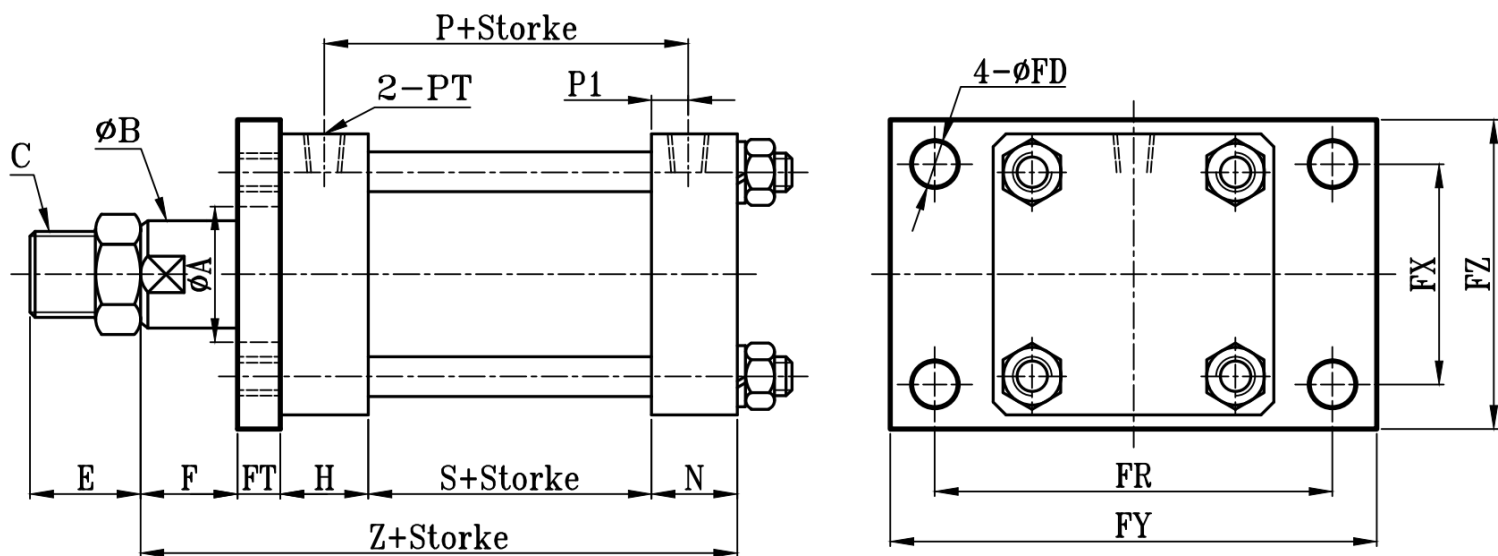

HOD:HOD+FA TYPE

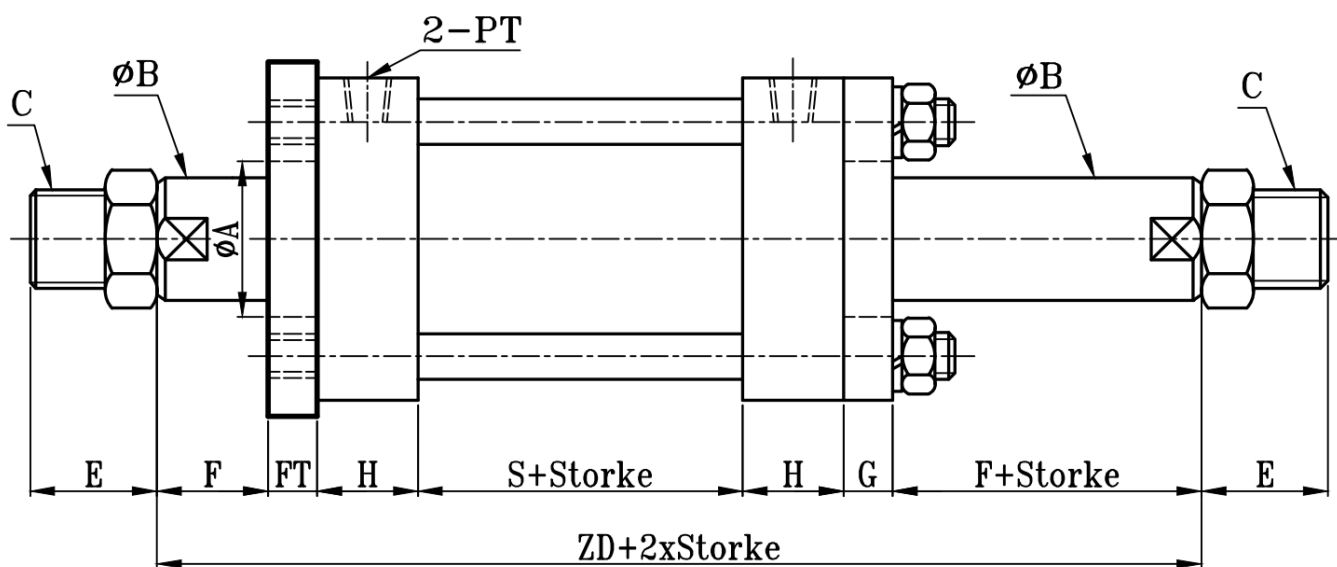

缸径 BORE	HOB-HOD TYPE														FA TYPE					
	$\Phi A$	$\Phi B$	C	E	F	G	H	N	P	P1	PT	S	Z	ZD	$\Phi FD$	FT	FR	FX	FY	FZ
$\Phi 32$	31	18	M16xP1.5	30	15	14	28	25	71	10.5	1/4"	50	132	164	12	14	80	35	100	55
$\Phi 40$	38	25	M22xP1.5	35	20	14	28	25	71	10.5	3/8"	50	137	174	12	14	93	50	115	70
$\Phi 50$	44	30	M26xP1.5	40	20	16	33	28	80	12.5	3/8"	55	152	193	14	16	110	56	135	85
$\Phi 63$	49	35	M30xP1.5	40	20	16	33	28	80	12.5	3/8"	55	152	193	16	16	126	68	155	95
$\Phi 80$	54	40	M30xP1.5 M36xP1.5 可选	45	25	18	38	33	91	15.5	1/2"	60	174	222	18	18	152	75	190	120
$\Phi 100$	64	50	M40xP2.0	50	25	20	38	33	111	15.5	1/2"	80	196	246	20	20	180	100	220	140
$\Phi 125$	74	60	M50xP2.0	60	30	24	43	38	116	18	3/4"	80	215	274	24	24	222	122	270	170
$\Phi 150$	97	80	M70xP2.0	80	30	29	48	43	130	20	3/4"	90	240	304	29	29	260	155	315	210
$\Phi 160$	97	80	M70xP2.0	80	30	29	48	43	130	20	3/4"	90	240	304	29	29	270	165	325	220
$\Phi 180$	117	100	M90xP2.0	100	35	34	58	48	146	23	1"	100	275	354	32	34	315	188	375	250
$\Phi 200$	117	100	M90xP2.0	100	35	39	58	53	146	23	1"	100	285	364	35	39	355	207	425	275
$\Phi 220$	150	125	M100xP3.0	110	35	44	68	58	166	28	1 1/4"	110	315	404	38	44	375	225	450	300
$\Phi 250$	150	125	M100xP3.0	110	35	49	68	63	166	28	1 1/4"	110	325	414	41	49	410	250	490	330