

非常簡單實用,隻需要很小的空間就可以安裝固定。

Simple but utility, just need small space to install and fix

Material 材質	Hardness 硬度
1.8159	HRC45°±3°

Type	尺寸/Dimension									荷重/load K(kgf)
	A	B	C	E	F	G	H	R	J	
JHN24.123006	12	30	6x20	21	5	4	16	6	M5x16	5
JHN24.164008	16	40	8x20	28	6	5	15	8	M6x25	7
JHN24.205010	20	50	10x24	34	8	6	17	10	M8x30	14
JHN24.246012	24	60	12x32	42	10	7	23	12	M10x40	21
JHN24.328012	32	80	16x40	56	12	9	27	16	M12x50	28
JHN24.328016					16		25			38

\*注意: "K"的取值, 決定釋放限位夾夾力的大小。 Note: "K"'s choose is per the force to release .

2D下載

3D下載

返回索引

標準限位夾, 對延遲模具的分開和閉合是非常有用的, 它能夠通過增加夾子的數量來增大限位夾的荷重。

Standard locating clamps are very useful to postpone the open and close of the mold. It can increase the locating clamp's load by add clamps.

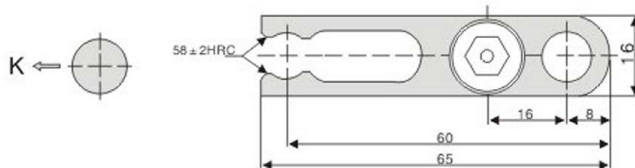
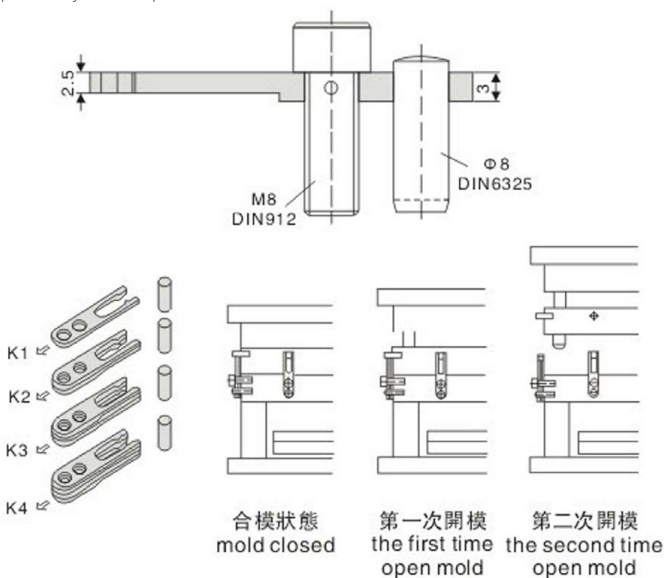

Material 材質	Hardness 硬度
1.8159	HRC45°±3°

※注意: 下表中的荷重值是通過安裝一、二、三或更多的夾子而得來的, 它是一組近似值, 僅供參考。

Note: The load datas are from installed clamps, they are approximation just for reference.

Type	荷重/load(kgf)			
JHN25.651608	K1	K2	K3	K4
	7.5	15	22.5	30

2D下載

3D下載

返回索引