

與英制PPSL系列不同的是: PPSM系列, 其螺絲和鎖緊銷釘采用的是公制標準。

Different from U.K standard PPSL series:

the screw and dowel pins in PPSM are in metric system standard .

Material 材質	Hardness 硬度
8620steel	HRC58°~62°

Type	尺寸/ Dimension											荷重 /load	Screw 限位螺絲
	A	B	C	D	E	*F	H	P	M	S	T	Kgf	
JHN19-01	38	19	16	7	31.5	24.89	15.5	6	M5	6	32	10	PM5x20
JHN19-02	54	32	20	11	43.0	34.93	22.5	8	M6	8	40	20	PM6x25
JHN19-03	86	45	30	19	67.0	53.98	40.0	10	M8	10	60	40	PM8x40

2D下載

3D下載

返回索引

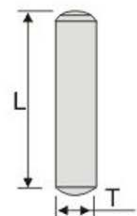
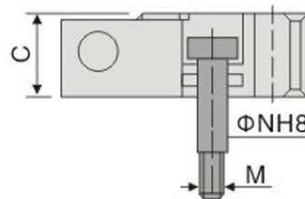
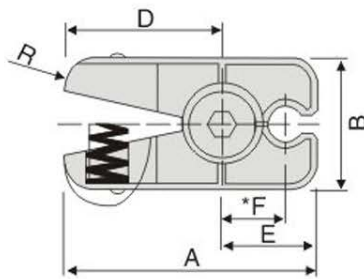

相對來說, 該系列的限位夾"F"距高更短, 鎖住的配合更加精密。

Relative, "F" length in this series is shorter,

and the lock cooperate more precision.

Material 材質	Hardness 硬度
8620steel	HRC58°~62°

Type	尺寸/ Dimension											荷重 /load	Screw 限位螺絲
	A	B	C	D	E	*F	R	M	N	T	L	Kgf	
JHN20-10M	38	19	16	22	16	9.15	5	M5	6	6	30	10	PM5x16
JHN20-20M	54	32	20	33	21	12.7	6	M6	8	8	40	20	PM6x20
JHN20-40M	86	45	30	53	33	20.3	10	M8	10	10	60	40	PM8x30

2D下載

3D下載

返回索引